

FORSHAW

Edgewater

"EXTERUS EXPRESS"®



Prices do not include tax or labor (must be field bid)

Summerset

MSRP

\$ 6,628

Features: This 6' outdoor kitchen is designed for value with a 32" Sizzler Summerset grill, double access doors, and large trash drawer. A stock Santa Cecilia granite top and Acacia Valley tile offer a great finishing package. Granite and tile come ready to install at the project site.

EXTERUSOUTDOOR.COM | (800) FORSHAW

FORSHAW

Edgewater

"EXTERUS EXPRESS"®

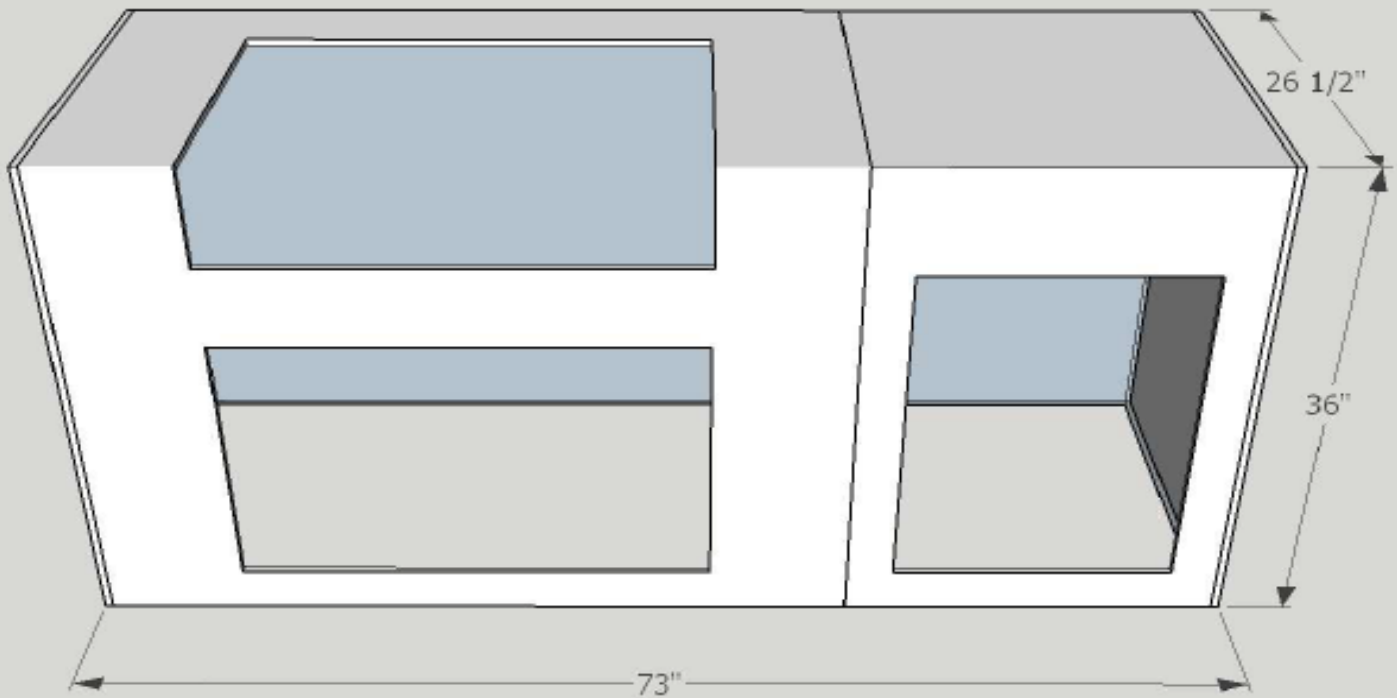

Prices do not include tax or labor (must be field bid)

Includes:	Quantity	Item	MSRP
32" grill	1	SIZ32	\$ 1,875
Double access doors	1	SSDD-33	\$ 425
Trash drawer	1	SSTD1-20	\$ 600
48" grill module	1	48G	\$ 675
24" door module	1	24D	\$ 385
Santa Cecelia polished top	1	SCL/L/P/E	\$ 1,420
Acacia Valley Tile	6	AV12	\$ 1,248

EXTERUSOUTDOOR.COM | (800) FORSHAW

FORSHAW

Melbourne

"EXTERUS TO GO"®



Prices do not include tax or labor (must be field bid)

MSRP

American Outdoor Grill

\$ 8,086

Features: This 6' outdoor kitchen is designed for value with an AOG 30" L series grill, double access doors, and triple drawer storage. This kitchen comes finished with Africa Persa polished granite countertop with eased edge and Fir strip tile. See our main brochure for granite and tile options.

EXTERUSOUTDOOR.COM | (800) FORSHAW

FORSHAW

Melbourne

"EXTERUS TO GO"®

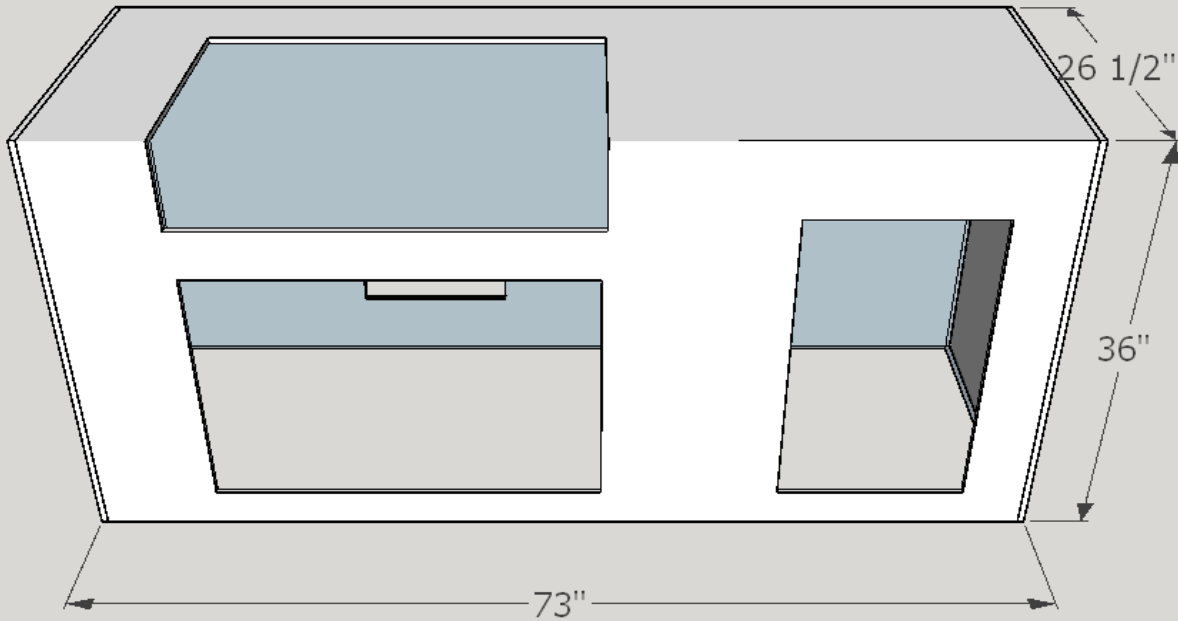

Prices do not include tax or labor (must be field bid)

Includes:	Quantity	Item	MSRP
30" grill	1	30NBL	\$ 2,683
Double access doors	1	33930S	\$ 534
Triple Drawer	1	33803	\$ 954
72" Grill/Drawer module	1	72GD	\$ 1,040
Africa Persa polished granite top	1	AP/L/P/E	\$ 1,675
Fir Strip Tile	5	IF0848F	\$ 700
Finishing	1		\$ 500

EXTERUSOUTDOOR.COM | (800) FORSHAW

FORSHAW

Palm Bay

"EXTERUS EXPRESS"®



Prices do not include tax or labor (must be field bid)

Fire Magic

MSRP

\$ 14,700

Features: This 7' outdoor kitchen offers a show-stopping 30" Echelon analog grill and 24" True glass door refrigerator. Take your grilling to the next level and keep your drinks cold. Finishes with an New Venetian Gold polished granite countertop with eased edge, and Boral stacked stone. Granite and stone come ready to install at the project site.

EXTERUSOUTDOOR.COM | (800) FORSHAW

FORSHAW

Palm Bay

"EXTERUS EXPRESS"®

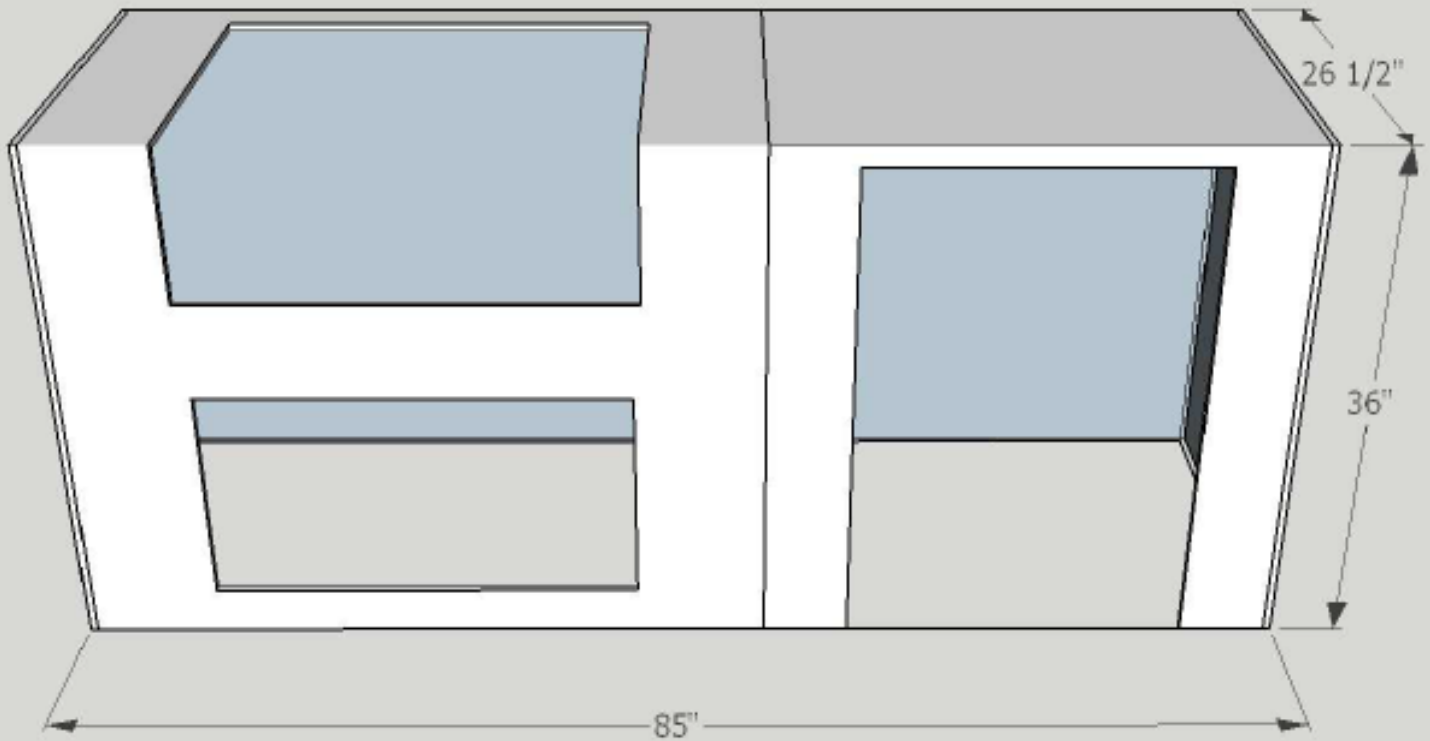

Prices do not include tax or labor (must be field bid)

Includes:	Quantity	Item	MSRP
30" Echelon analog grill	1	E660I-4EAN	\$ 6,271
Double access doors	1	53934S	\$ 478
True 24" glass door refrigerator	1	TUR-24-SG-R-B	\$ 3,489
48" grill module	1	48G	\$ 675
36" fridge module	1	36F	\$ 440
New Venetian Gold granite top	1	NVG/L/P/E	\$ 1,675
Boral stacked stone - flats	6	MBB-701531679	\$ 1,272
Boral stacked stone - corners	2	MBB-701531693	\$ 400

EXTERUSOUTDOOR.COM | (800) FORSHAW

FORSHAW

Palmetto

"EXTERUS EXPRESS"®



Prices do not include tax or labor (must be field bid)

MSRP

American Outdoor Grill

\$ 8,791

Features: This 7' outdoor kitchen offers a simple, functional package. It comes with an AOG 36" L series grill with interior halogen lights, double access doors, a 20" AOG refrigerator, an Africa Persa leather granite countertop with eased edge, and Eldorado stone. Granite and stone come ready to install at the project site.

EXTERUSOUTDOOR.COM | (800) FORSHAW

FORSHAW

Palmetto

"EXTERUS EXPRESS"®

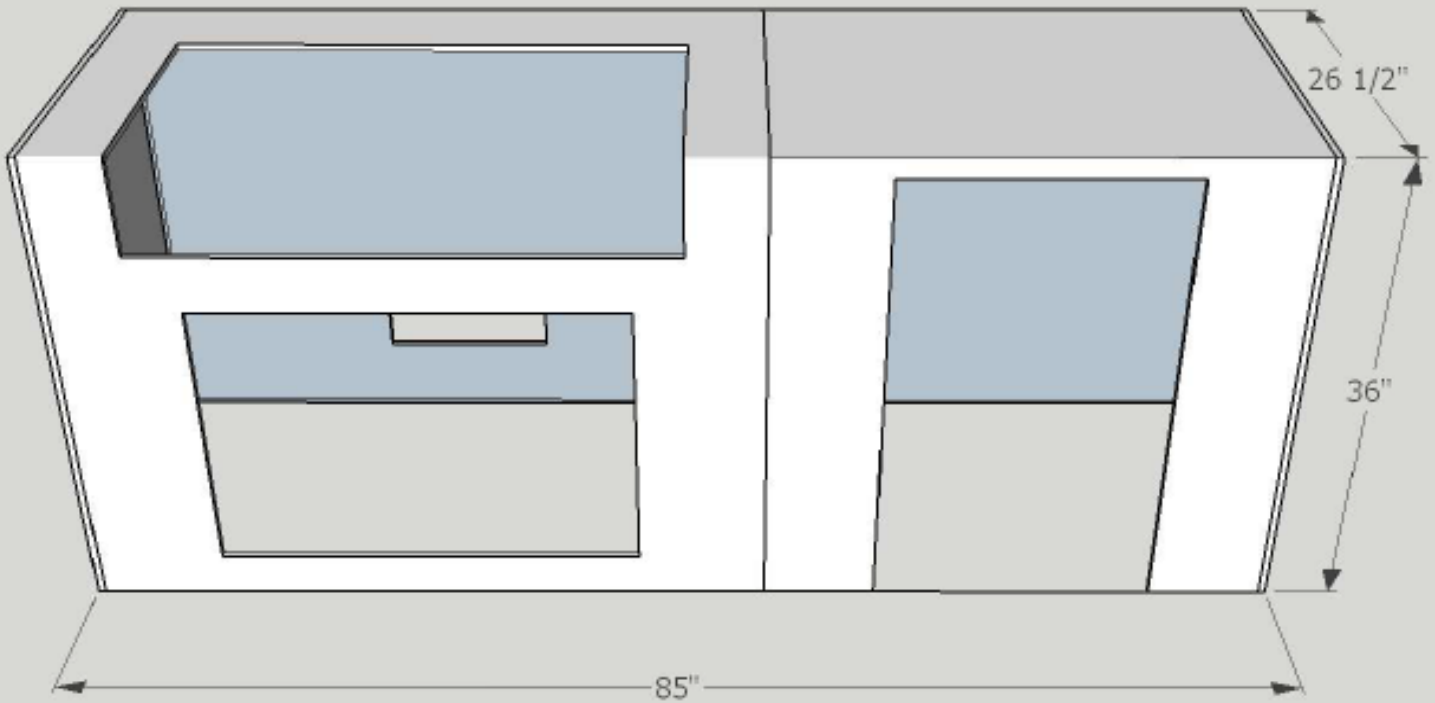

Prices do not include tax or labor (must be field bid)

Includes:	Quantity	Item	MSRP
36" Grill	1	36NBL	\$ 2,799
Double access doors	1	33930S	\$ 534
Refrigerator	1	REF-21	\$ 558
48" grill module	1	48G	\$ 675
36" fridge module	1	36F	\$ 440
Africa Persa leather granite top	1	AP/L/L/E	\$ 1,805
Eldorado stone	9	MBB-7147901F0	\$ 1,980

EXTERUSOUTDOOR.COM | (800) FORSHAW

FORSHAW

Charcoal Cay

"EXTERUS EXPRESS"®



Prices do not include tax or labor (must be field bid)

Fire Magic

MSRP

\$ 13,337

This sleek, modern kitchen offers a 36" Echelon Black Diamond grill with Magic View ceramic window, black porcelain double doors, and a large 300 series Primo oval grill. Enjoy the convenience of gas along with the flavor and versatility of a ceramic charcoal grill in this compact package! Yacht Club tile and Pauline Grey countertop come ready to install at the project site.

EXTERUSOUTDOOR.COM | (800) FORSHAW

FORSHAW

Charcoal Cay

"EXTERUS EXPRESS"®

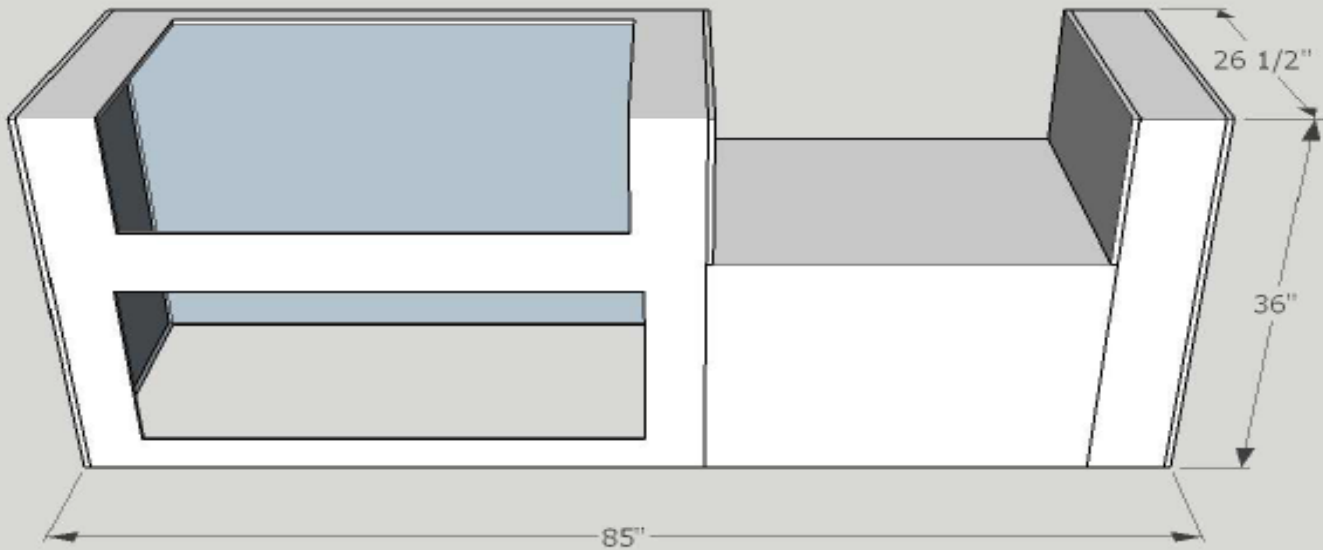

Prices do not include tax or labor (must be field bid)

Includes:	Quantity	Item	MSRP
Echelon Diamond Grill	1	H790i-4E1N-W	\$ 8,448
Double Access Door	1	53938HSC	\$ 666
Large 300 Oval	1	775	\$ 1,166
48" grill module	1	48G	\$ 675
30" kamado module	1	30B-K	\$ 335
6" filler module	1	6B	\$ 210
Yacht Club tile	6	YC-CARTON	\$ 672
Pauline Grey polished granite top	1	PG/L/P/E	\$ 1,165

EXTERUSOUTDOOR.COM | (800) FORSHAW