

**FORSHAW**

**Edgewater**

**"EXTERUS EXPRESS"®**



\*\*Prices do not include tax or labor (must be field bid)\*\*

**MSRP**

**Summerset**

**\$ 5,955**

**Features:** This 6' outdoor kitchen is designed for value with a 32" Sizzler Summerset grill, double access doors, and large trash drawer. A stock Santa Cecelia granite top and Texas Cream Timber Ledge stone offer a great finishing package. Granite and stone come ready to install at the project site.

**EXTERUSOUTDOOR.COM | (800) FORSHAW | FORSHAW, INC.**

# FORSHAW

# Edgewater

## "EXTERUS EXPRESS"®

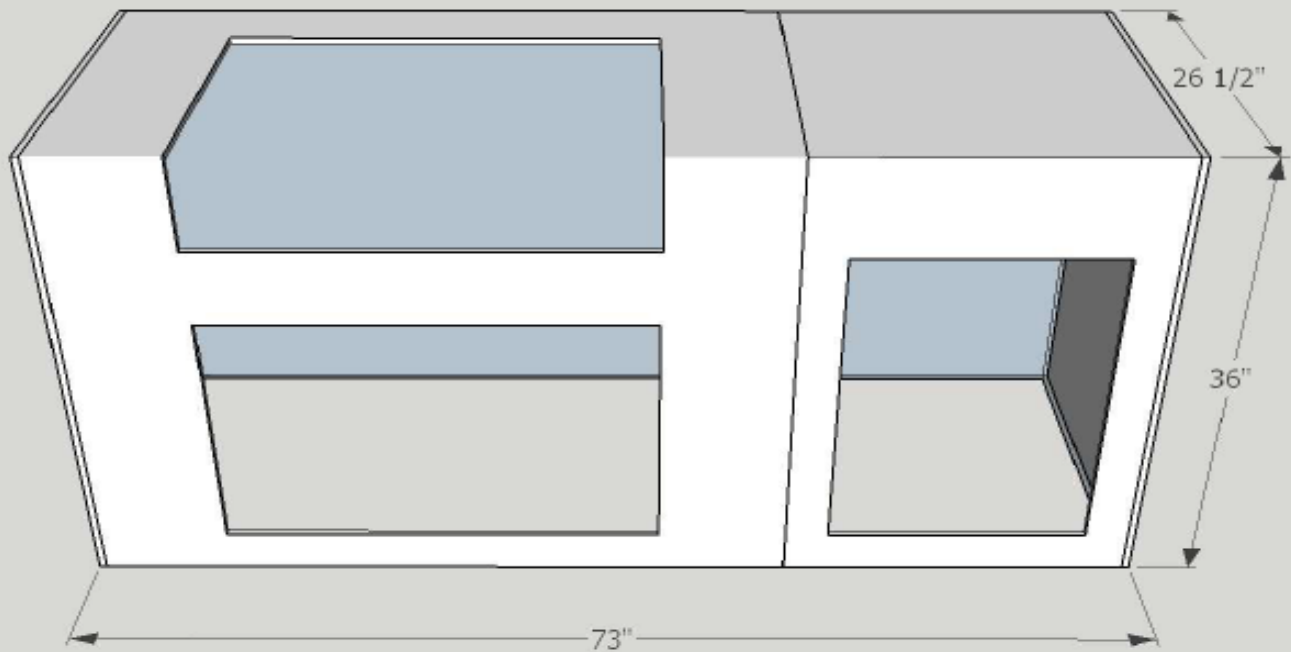

\*\*Prices do not include tax or labor (must be field bid)\*\*

Includes:	Quantity	Item	MSRP
32" grill	1	SIZ32	\$ 1,699
Double access doors	1	SSDD-30	\$ 399
Trash drawer	1	SSTD-1	\$ 559
48" grill module	1	48G	\$ 635
24" door module	1	24D	\$ 355
Santa Cecelia polished top	1	SCL/L/P/E	\$ 1,420
Texas cream flat boxes - timber ledge	6	TL/TC/F/HP	\$ 600
Texas cream corner box - timber ledge	2	TL/TC/C/HP	\$ 288

EXTERUSOUTDOOR.COM | (800) FORSHAW | FORSHAW, INC.

# FORSHAW

# Melbourne

## "EXTERUS EXPRESS"®



\*\*Prices do not include tax or labor (must be field bid)\*\*

MSRP

AOG

\$ 6,459

**Features:** This 6' outdoor kitchen is designed for value with an AOG 30" T series grill, double access doors, and triple drawer storage. Finish with a contemporary flair: Pauline Grey polished granite countertop with eased edge, and Timber Ledge Midnight Black stone. Granite and stone come ready to install at the project site.

EXTERUSOUTDOOR.COM | (800) FORSHAW | FORSHAW, INC.

# FORSHAW

# Melbourne

## "EXTERUS EXPRESS"®

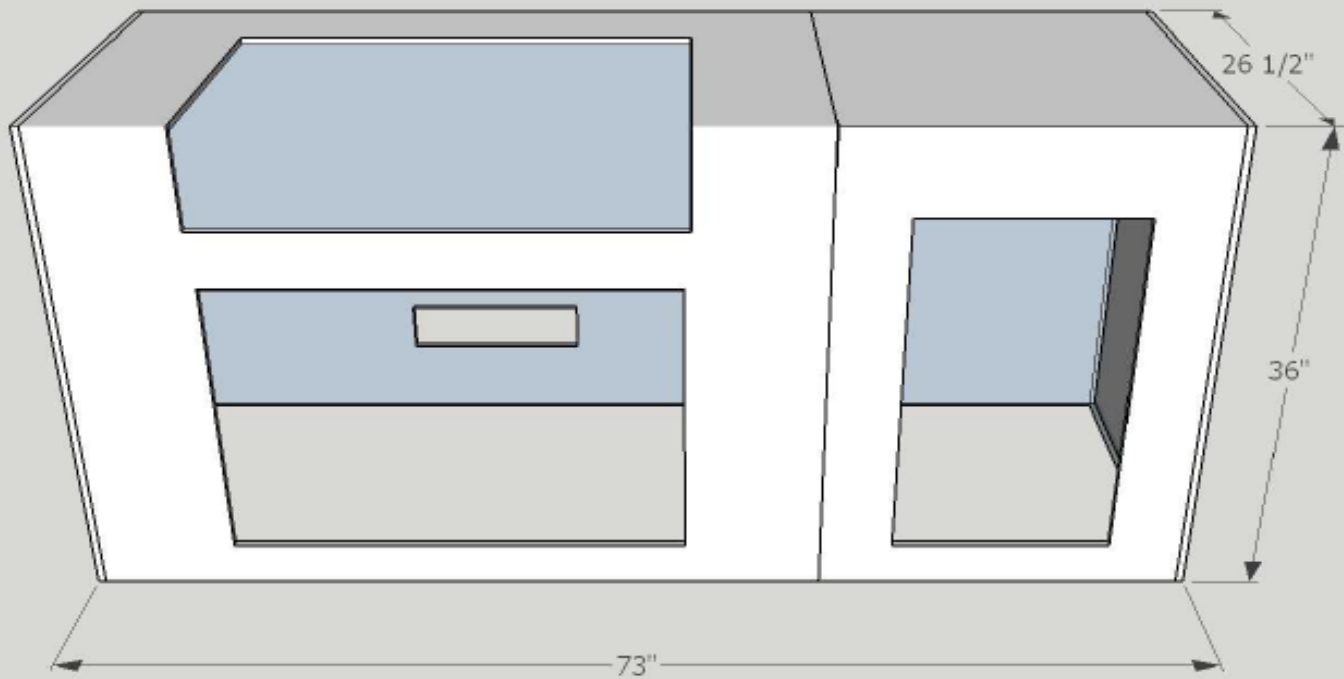

\*\*Prices do not include tax or labor (must be field bid)\*\*

Includes:	Quantity	Item	MSRP
30" grill	1	30NBT	\$ 2,053
Double access doors	1	33930S	\$ 471
Triple Drawer	1	33803	\$ 892
48" grill module	1	48G	\$ 635
24" door module	1	24D	\$ 355
Pauline Grey polished granite top	1	PG/L/P/E	\$ 1,165
Midnight black flat boxes - timber ledge	6	TL/TC/F/HP	\$ 600
Midnight black corner box - timber ledge	2	TL/TC/C/HP	\$ 288

EXTERUSOUTDOOR.COM | (800) FORSHAW | FORSHAW, INC.

**FORSHAW**

# Palm Bay

**"EXTERUS EXPRESS"®**



\*\*Prices do not include tax or labor (must be field bid)\*\*

**MSRP**

Fire Magic

**\$ 13,138**

**Features:** This 7' outdoor kitchen offers a show-stopping 30" Echelon analog grill and 24" True glass door refrigerator. Take your grilling to the next level and keep your drinks cold. Finishes with an Africa Persa polished granite countertop with eased edge, and Timber Ledge Sienna stone. Granite and stone come ready to install at the project site.

**EXTERUSOUTDOOR.COM | (800) FORSHAW | FORSHAW, INC.**

# FORSHAW

# Palm Bay

## "EXTERUS EXPRESS"®

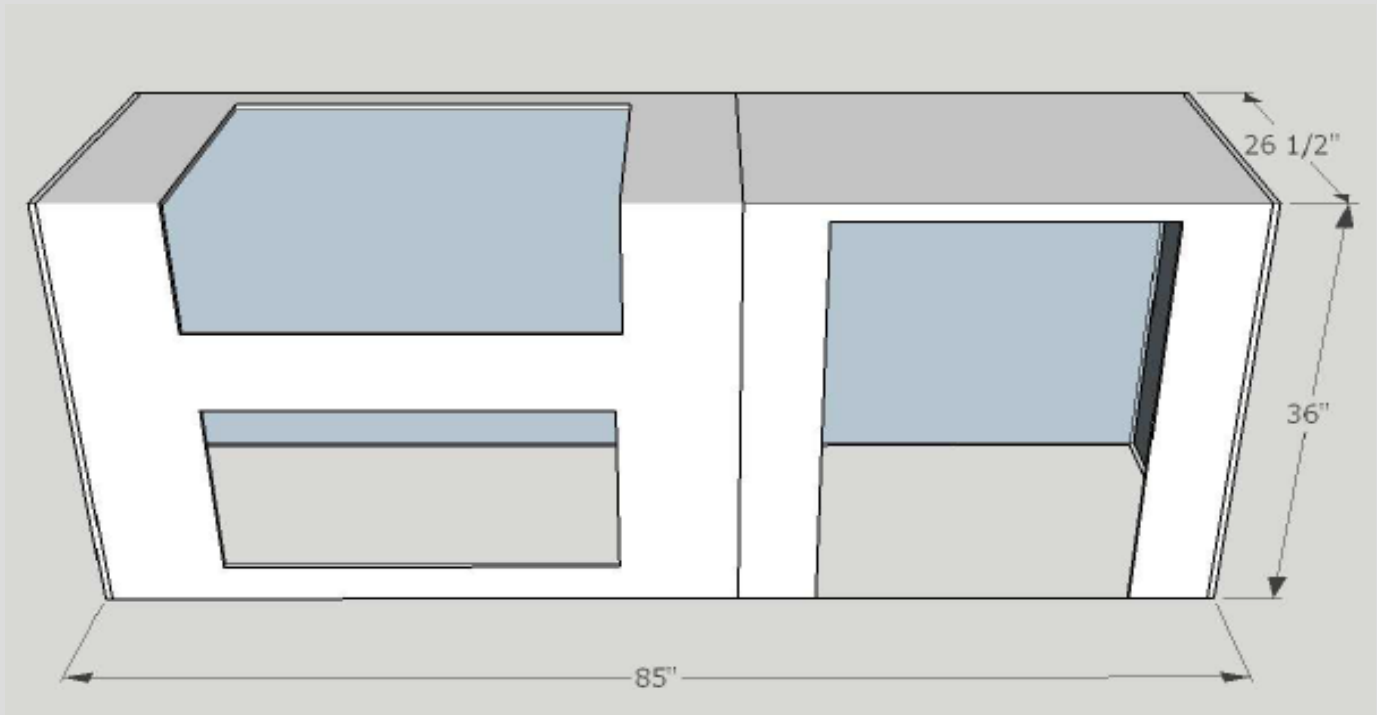

\*\*Prices do not include tax or labor (must be field bid)\*\*

Includes:	Quantity	Item	MSRP
30" Echelon analog grill	1	E660I-4EAN	\$ 5,770
Double access doors	1	53934S	\$ 447
True 24" glass door refrigerator	1	TUR-24-SG-R-B	\$ 3,213
48" grill module	1	48G	\$ 635
36" fridge module	1	36F	\$ 410
Africa Persa polished granite top	1	AP/L/P/E	\$ 1,675
Sienna flat boxes - timber ledge	7	TL/SN/F/HP	\$ 700
Sienna corner box - timber ledge	2	TL/SN/C/HP	\$ 288

EXTERUSOUTDOOR.COM | (800) FORSHAW | FORSHAW, INC.

# FORSHAW

# Palmetto

## "EXTERUS EXPRESS"®



\*\*Prices do not include tax or labor (must be field bid)\*\*

MSRP

AOG

\$ 7,290

**Features:** This 7' outdoor kitchen offers a simple, functional package. It comes with an AOG 36" L series grill with interior halogen lights, double access doors, a 20" AOG refrigerator, an Africa Persa polished granite countertop with eased edge, and Timber Ledge Texas Cream stone. Granite and stone come ready to install at the project site.

EXTERUSOUTDOOR.COM | (800) FORSHAW | FORSHAW, INC.

# FORSHAW

# Palmetto

## "EXTERUS EXPRESS"®

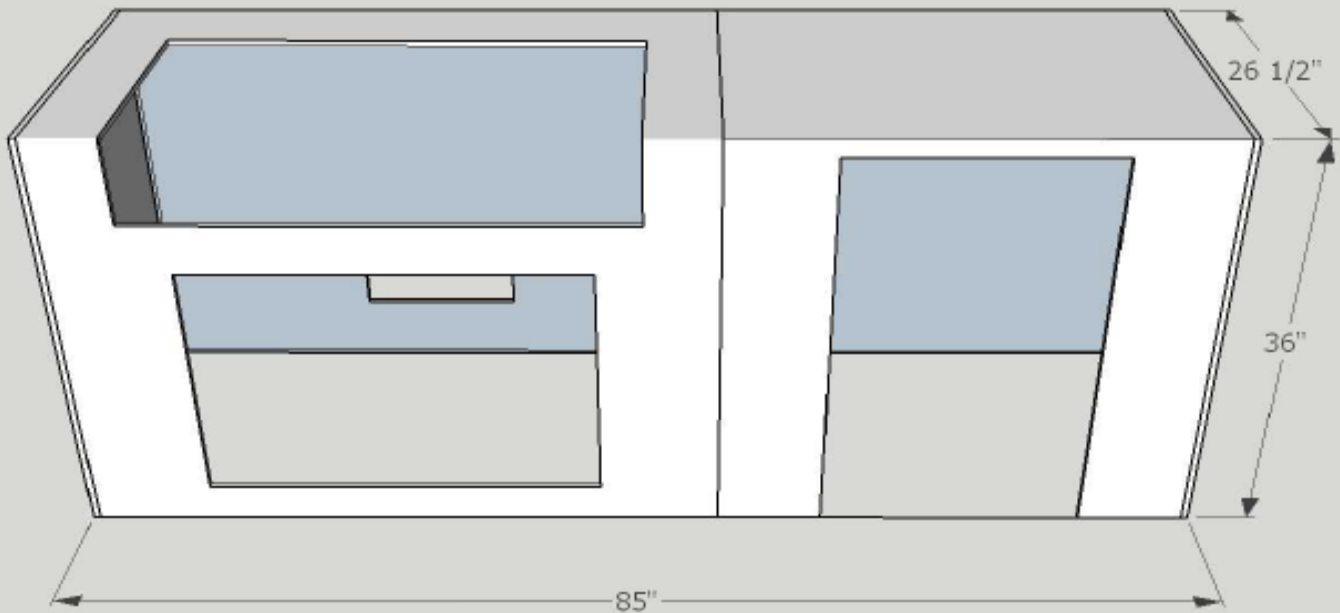

\*\*Prices do not include tax or labor (must be field bid)\*\*

Includes:	Quantity	Item	MSRP
36" Grill	1	36NBL	\$ 2,481
Double access doors	1	33930S	\$ 471
Refrigerator	1	REF-20	\$ 630
48" grill module	1	48G	\$ 635
36" fridge module	1	36F	\$ 410
Africa Persa polished granite top	1	AP/L/P/E	\$ 1,675
Texas cream flat boxes - timber ledge	7	TL/TC/F/HP	\$ 700
Texas cream corner box - timber ledge	2	TL/TC/C/HP	\$ 288



# FORSHAW

# Charcoal Cay

*"EXTERUS EXPRESS"®*



\*\*Prices do not include tax or labor (must be field bid)\*\*

**MSRP**

**Fire Magic**

**\$ 12,795**

This sleek, modern kitchen offers a 36" Echelon black diamond grill with magic view ceramic window, black porcelain double doors, and a large 300 series Primo oval grill. Enjoy the convenience of gas along with the flavor and versatility of a ceramic charcoal grill in this compact package! Charcoal tile and Pauline grey countertop come ready to install at the project site.

[EXTERUSOUTDOOR.COM](http://EXTERUSOUTDOOR.COM) | (800) FORSHAW | FORSHAW, INC.

# FORSHAW

# Charcoal Cay

## "EXTERUS EXPRESS"®

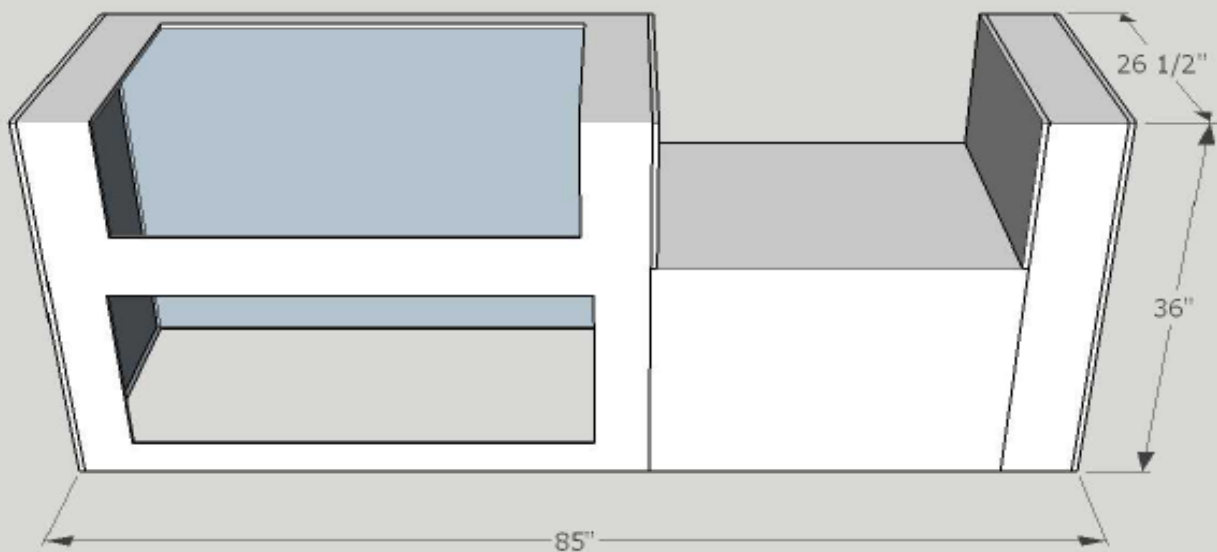

\*\*Prices do not include tax or labor (must be field bid)\*\*

Includes:	Quantity	Item	MSRP
Echelon Diamond Grill	1	H790i-4E1N-W	\$ 7,720
Double Access Door	1	53920H-SR/L	\$ 622
Large 300 Oval	1	775	\$ 1,118
48" grill module	1	48G	\$ 635
30" kamado module	1	30B-K	\$ 310
6" filler module	1	6B	\$ 205
Yacht club tile	6	YC-CARTON	\$ 1,020
Pauline Grey polished granite top	1	PG/L/P/E	\$ 1,165

EXTERUSOUTDOOR.COM | (800) FORSHAW | FORSHAW, INC.